

**LEGEND**

**CLASS I, TYPE A**  
(NAG - S75 OR APPROVED EQUAL)

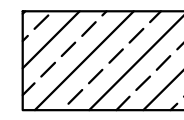

**CLASS II, TYPE B**  
(NAG - S150 OR APPROVED EQUAL)

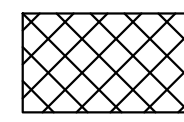

**CLASS III, TYPE A**  
(NAG - S150 OR APPROVED EQUAL)

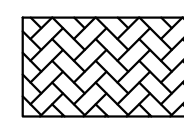

**GRAVEL TRACKING PAD**

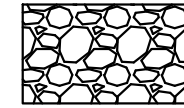

**SILT FENCE**

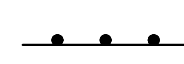

**SEDIMENT LOG**



**INLET PROTECTION TYPE D**



**NOTES:**

- ALL GRATED STORM INLETS WILL BE PROTECTED WITH TYPE D INLET PROTECTION.
- MATERIAL AND TOPSOIL STOCKPILES FOR PHASE 1 WILL BE PROTECTED ON ALL SIDE AND DOWNSLOPES WITH SILT FENCE. ANY STOCKPILE INACTIVE FOR GREATER THAN 7 DAYS WILL BE TEMPORARILY SEEDED.

**TOTAL LAND DISTURBANCES:**

PHASE 1 = 11.73 ACRES  
PHASE 2 = 57.36 ACRES  
TOTAL WOODLAND AREA REMOVED = 2.99 ACRES

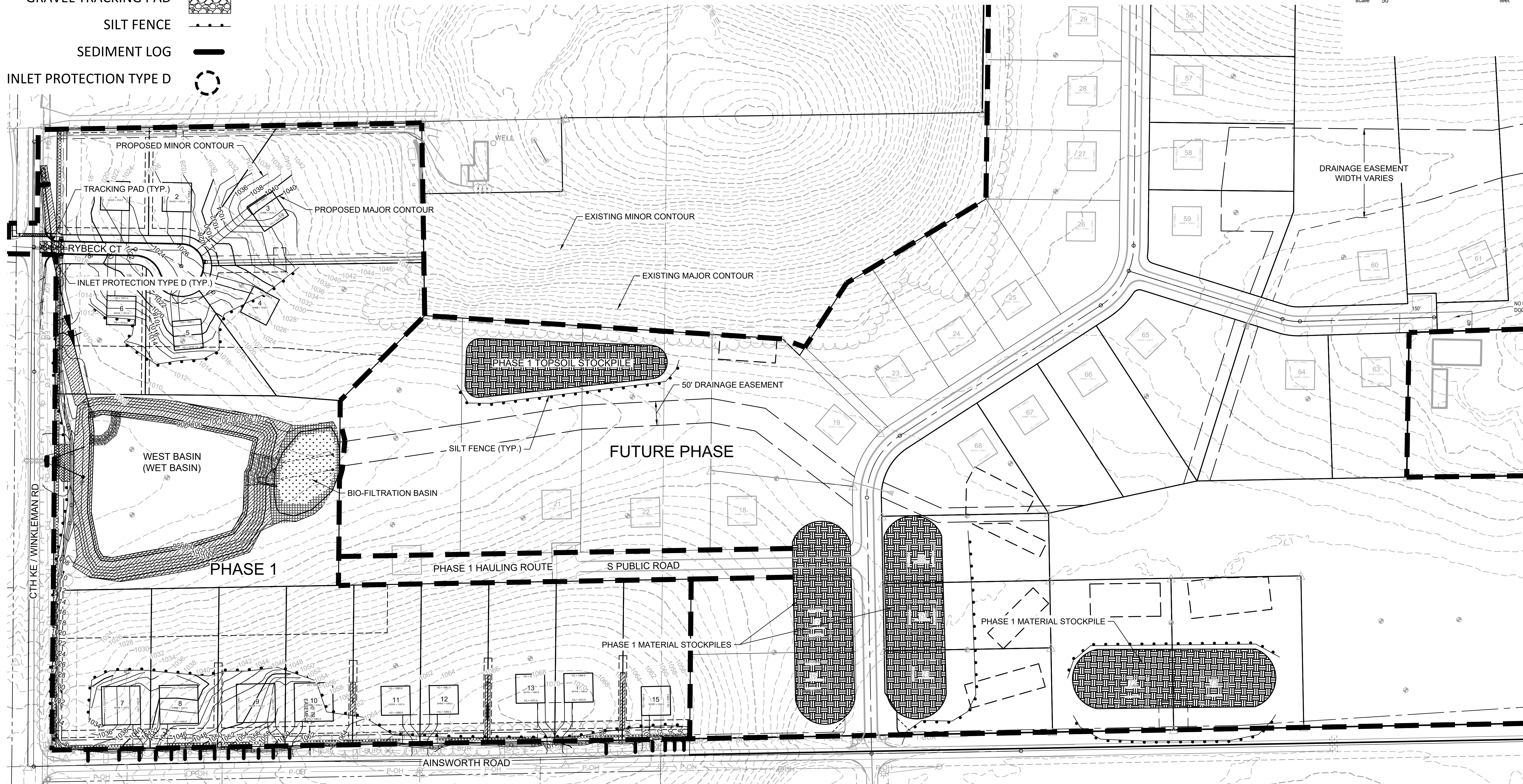
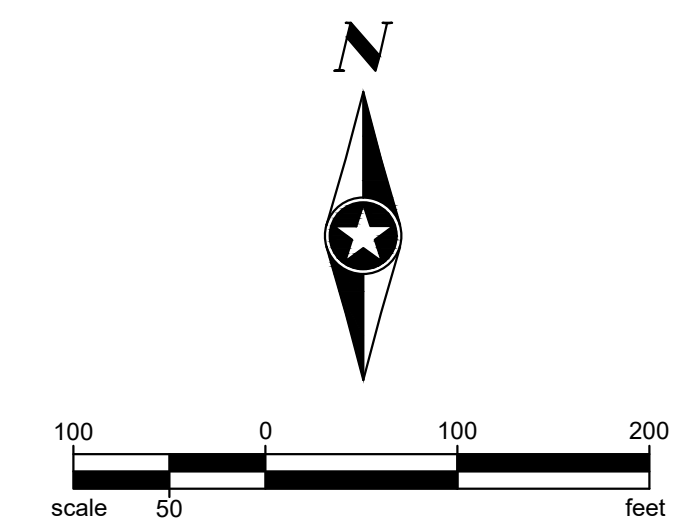

DRAWN BY: MRG  
DESIGNER: MRG  
CHECKED BY: BTP

NO.	BY	DATE	REVISIONS

PHONE: 262.646.6855  
501 MAPLE AVENUE  
DELAFIELD, WI 53018  
www.sehinc.com

**STONE RIDGE SUBDIVISION  
VILLAGE OF MERTON, WISCONSIN**

**INTERIM GRADING AND EROSION  
CONTROL PLAN - PHASE 1**

FILE NO. C2.00  
146836 HALQA  
16



**LEGEND**

**CLASS I, TYPE A**  
(NAG - S75 OR APPROVED EQUAL)

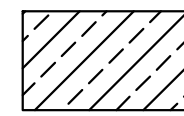

**CLASS II, TYPE B**  
(NAG - S150 OR APPROVED EQUAL)



**CLASS III, TYPE A**  
(NAG - S150 OR APPROVED EQUAL)



**GRAVEL TRACKING PAD**

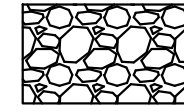

**SILT FENCE**

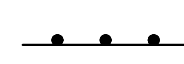

**SEDIMENT LOG**



**INLET PROTECTION TYPE D**



**NOTES:**

- ALL GRATED STORM INLETS WILL BE PROTECTED WITH TYPE D INLET PROTECTION.
- MATERIAL AND TOPSOIL STOCKPILES FOR PHASE 1 WILL BE PROTECTED ON ALL SIDE AND DOWNSLOPES WITH SILT FENCE. ANY STOCKPILE INACTIVE FOR GREATER THAN 7 DAYS WILL BE TEMPORARILY SEEDED.

**TOTAL LAND DISTURBANCES:**

PHASE 1 = 11.73 ACRES  
PHASE 2 = 57.36 ACRES  
TOTAL WOODLAND AREA REMOVED = 2.99 ACRES

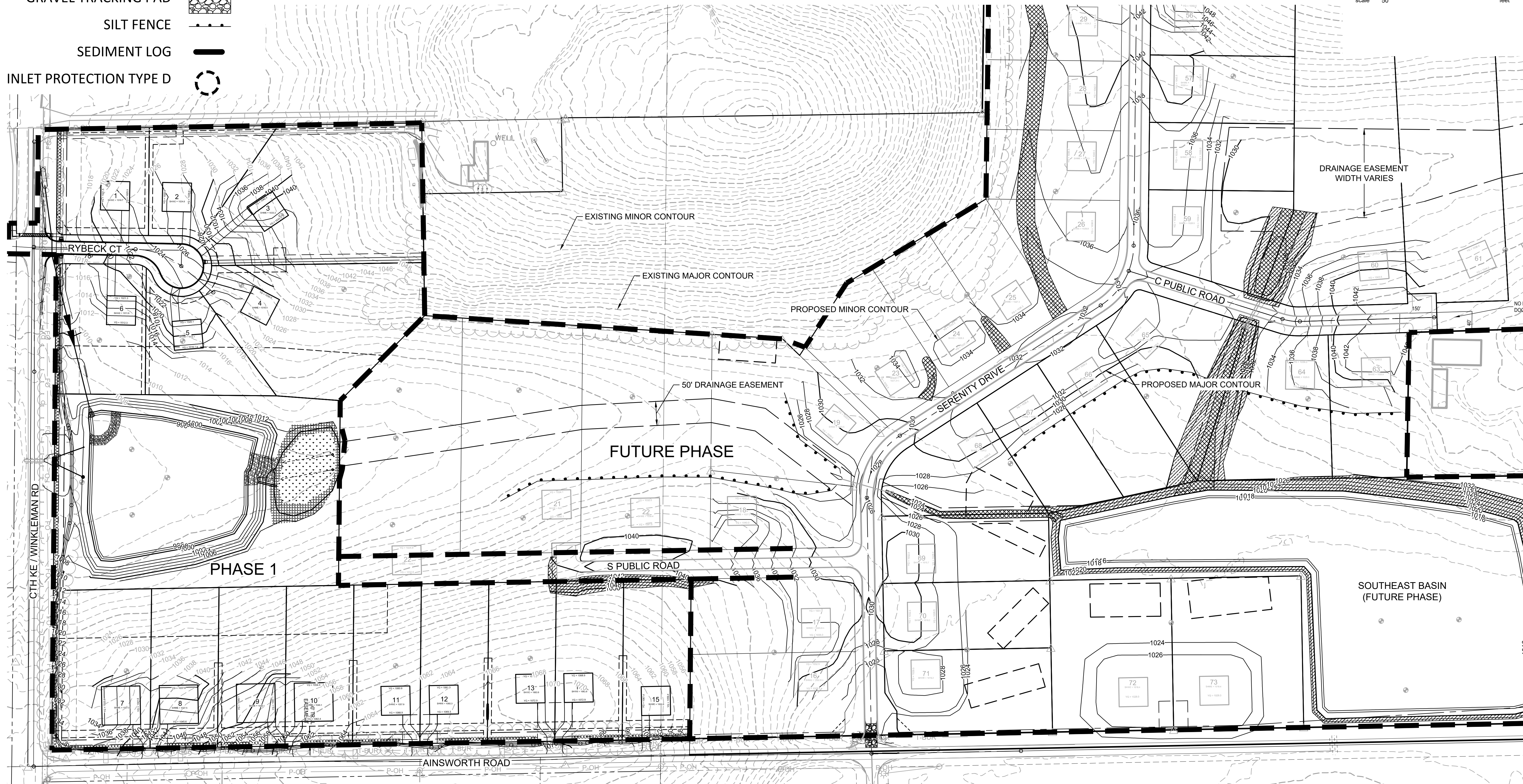
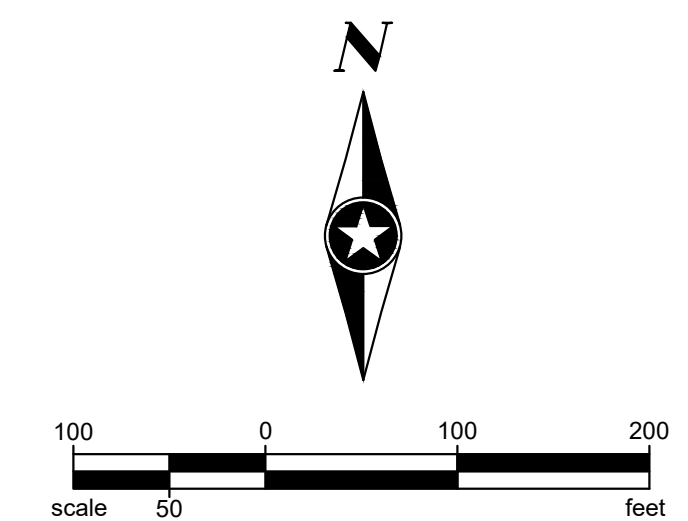

DRAWN BY: MRG  
DESIGNER: MRG  
CHECKED BY: BTP

NO.	BY	DATE	REVISIONS

PHONE: 262.646.6855  
501 MAPLE AVENUE  
DELAFIELD, WI 53018  
www.sehinc.com





**STONE RIDGE SUBDIVISION  
VILLAGE OF MERTON, WISCONSIN**

**INTERIM GRADING AND EROSION  
CONTROL PLAN - PHASE 2**

FILE NO. C2.00  
146836 HALQA  
16

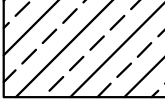
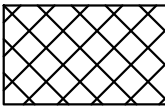

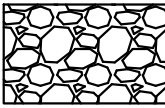
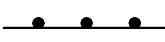
**LEGEND**

- CLASS I, TYPE A  
(NAG - S75 OR APPROVED EQUAL) 
- CLASS II, TYPE B  
(NAG - S150 OR APPROVED EQUAL) 
- CLASS III, TYPE A  
(NAG - S150 OR APPROVED EQUAL) 
- GRAVEL TRACKING PAD 
- SILT FENCE 
- SEDIMENT LOG 
- INLET PROTECTION TYPE D 

**NOTES:**

- ALL GRATED STORM INLETS WILL BE PROTECTED WITH TYPE D INLET PROTECTION.
- MATERIAL AND TOPSOIL STOCKPILES FOR PHASE 1 WILL BE PROTECTED ON ALL SIDE AND DOWNSLOPES WITH SILT FENCE. ANY STOCKPILE INACTIVE FOR GREATER THAN 7 DAYS WILL BE TEMPORARILY SEED.

**TOTAL LAND DISTURBANCES:**  
 PHASE 1 = 11.73 ACRES  
 PHASE 2 = 57.36 ACRES  
 TOTAL WOODLAND AREA REMOVED = 2.99 ACRES

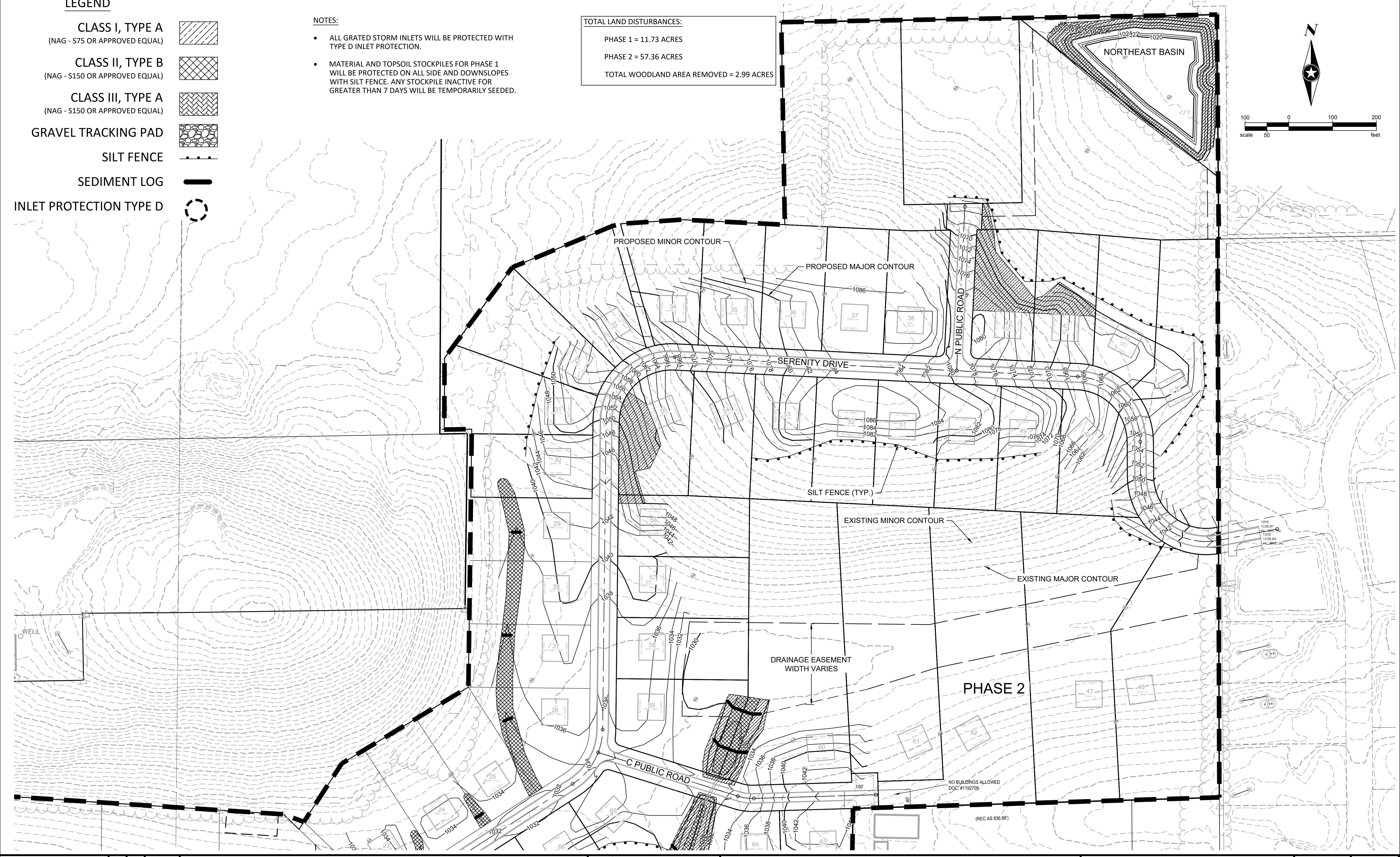
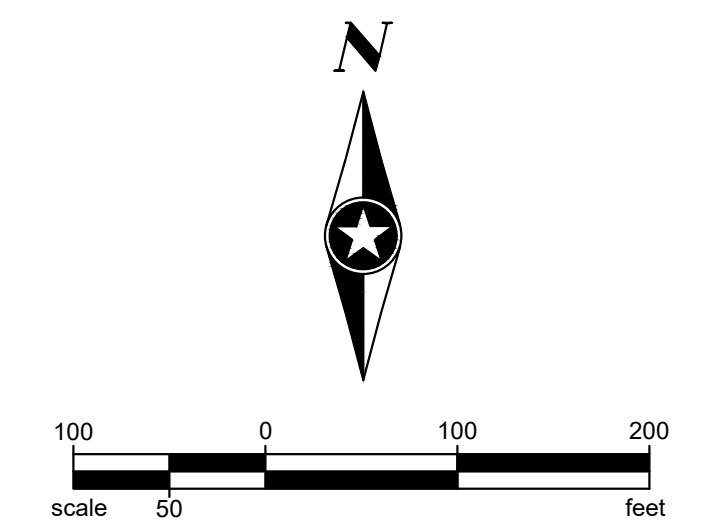

DRAWN BY: MRG  
 DESIGNER: MRG  
 CHECKED BY: BTP

DESIGN TEAM	NO.	BY	DATE	REVISIONS

**SEH**  
 PHONE: 262.646.6855  
 501 MAPLE AVENUE  
 DELAFIELD, WI 53018  
 www.sehinc.com

**STONE RIDGE SUBDIVISION  
 VILLAGE OF MERTON, WISCONSIN**

**INTERIM GRADING AND EROSION  
 CONTROL PLAN - PHASE 2**

FILE NO. C2.01  
 146836 HALQA  
 16